

# CoS Non-Permanent Design Builder

Standard  
Adaptive  
Facility  
Envelope



Single Story Option

## Roof Type

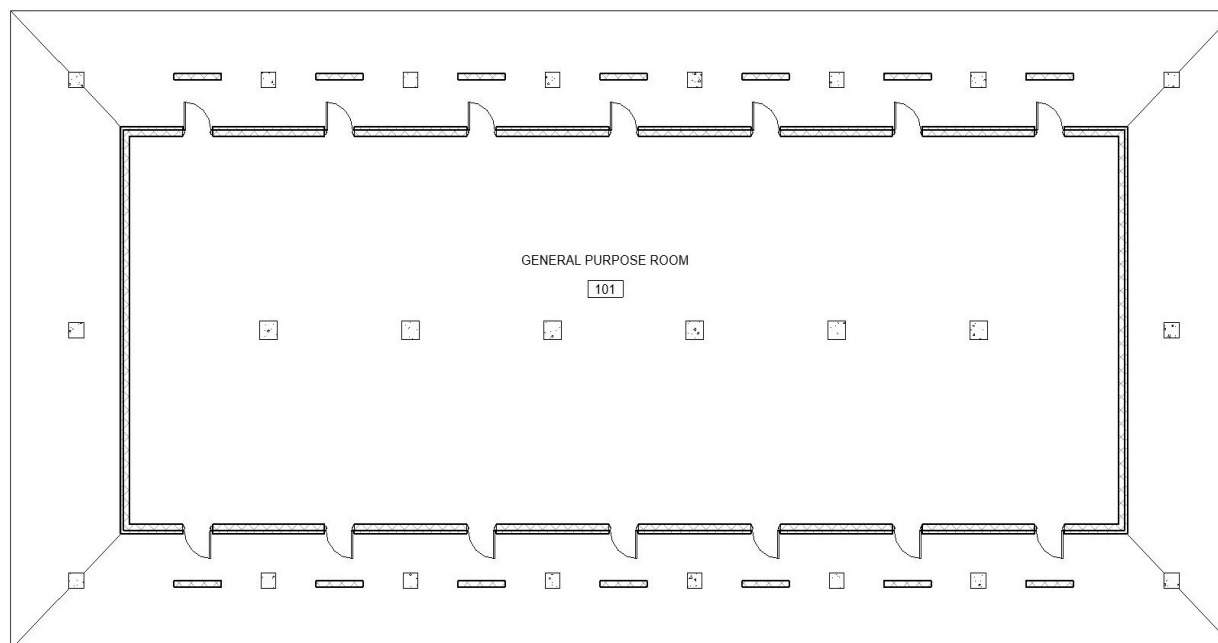
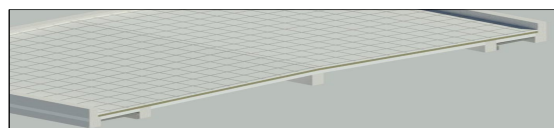

GENERAL PURPOSE ROOM

101



US Army Corps  
of Engineers®



Center of Standardization for  
Nonpermanent Facilities

## Design Title

Blank Floor Plan

## Rough Order of Magnitude (ROM)

ACF	1.23
\$/Unit	\$2,307
Size (M2)	442.5
ROM Breakdown	
Roof	\$202,950
Envelope	\$817,950
Interior	\$0
Total Facility	\$1,020,900
CoS Oversight (1%)	\$10,209
Total ROM	<b>\$1,031,109</b>

NOTE: This ROM does not include any FF&E, site work or utility connections. Area Cost Factors are based on 2018 PAX Newsletter.

## Description

a "bay" consists of a 24'x16' section. The default SAFE Envelope consists of 14 Bays. The facilities can be stretched or shortened modularly per "bay" width

Construction Material: Concrete Frame with CMU Infill

Roof Type: Protected structure with integral protective roof

Occupancy: semi-permanent facility to be occupied no more than 25 years.

## Interior Layout

### Design Preview

### Design Selection Criteria

Roof Type:	Protected Roof w/Parapet	Stories	Single Story
Proposed Location	California	Dimensions	14 Bay, 9.8m x 34.3m, 442.5 m2
Labor Execution:	Contractor	R-value	Wall 20; Roof 40
Interior Layout Detail	#N/A	Construction Material	Concrete Framing w/ CMU infill